

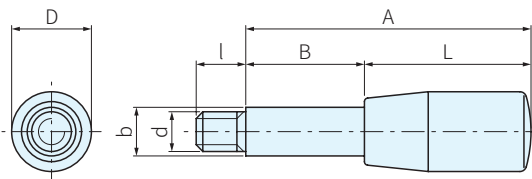

| Type | 手柄 | | 桿 | |
|--------|--------|----|----|----|
| | 材質 | 顏色 | 材質 | 處理 |
| BL.666 | PF(電木) | 黑 | 鋼 | 鍍鋅 |
| BL.668 | PA | | | |

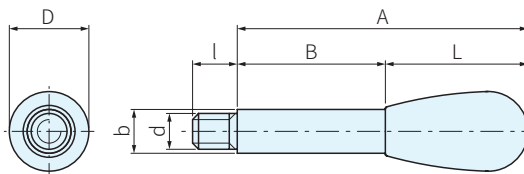

BL.666



BL.668

| 品號 | A | D | L | d 6g | B | b | l | 質量 g | 庫存 |
|------------|-----|----|----|---------|-----|----|----|---------|----|
| BL.666-010 | 65 | 14 | 28 | M6 | 37 | 8 | 8 | 22 | · |
| BL.666-020 | 75 | 14 | 28 | M6 | 47 | 8 | 8 | 25 | · |
| BL.666-030 | 95 | 14 | 28 | M6 | 67 | 8 | 8 | 33 | · |
| BL.666-040 | 65 | 18 | 40 | M8 | 25 | 10 | 9 | 35 | · |
| BL.666-050 | 75 | 18 | 40 | M8 | 35 | 10 | 9 | 40 | · |
| BL.666-060 | 85 | 21 | 50 | M8 | 35 | 10 | 9 | 48 | · |
| BL.666-070 | 95 | 21 | 50 | M8 | 45 | 10 | 9 | 55 | · |
| BL.666-080 | 125 | 21 | 50 | M8 | 75 | 10 | 9 | 73 | · |
| BL.666-090 | 155 | 21 | 50 | M8 | 105 | 10 | 11 | 92 | · |
| BL.666-100 | 102 | 23 | 65 | M10 | 37 | 12 | 14 | 80 | · |
| BL.666-110 | 118 | 23 | 65 | M10 | 53 | 12 | 14 | 95 | · |
| BL.666-120 | 165 | 23 | 65 | M10 | 100 | 12 | 14 | 138 | · |
| BL.666-130 | 203 | 23 | 65 | M10 | 138 | 12 | 14 | 165 | · |
| BL.666-140 | 125 | 26 | 80 | M12 | 45 | 14 | 15 | 130 | · |
| BL.666-150 | 160 | 26 | 80 | M12 | 80 | 14 | 15 | 165 | · |
| BL.666-160 | 200 | 26 | 80 | M12 | 120 | 14 | 15 | 220 | · |
| BL.666-170 | 105 | 28 | 90 | M14 | 15 | 16 | 15 | 120 | △ |
| BL.666-180 | 143 | 28 | 90 | M14 | 53 | 16 | 15 | 178 | △ |
| BL.666-190 | 164 | 28 | 90 | M14 | 74 | 16 | 15 | 210 | △ |
| BL.666-200 | 190 | 28 | 90 | M14 | 100 | 16 | 15 | 252 | △ |
| BL.668-010 | 57 | 20 | 32 | M8 | 25 | 10 | 9 | 31 | · |
| BL.668-020 | 67 | 20 | 32 | M8 | 35 | 10 | 9 | 37 | · |
| BL.668-030 | 77 | 20 | 32 | M8 | 45 | 10 | 9 | 43 | · |
| BL.668-040 | 107 | 20 | 32 | M8 | 75 | 10 | 9 | 62 | · |
| BL.668-050 | 137 | 20 | 32 | M8 | 105 | 10 | 11 | 81 | · |
| BL.668-060 | 79 | 26 | 42 | M10 | 37 | 12 | 14 | 65 | · |
| BL.668-070 | 95 | 26 | 42 | M10 | 53 | 12 | 14 | 79 | · |
| BL.668-080 | 142 | 26 | 42 | M10 | 100 | 12 | 14 | 122 | · |
| BL.668-090 | 180 | 26 | 42 | M10 | 138 | 12 | 14 | 154 | · |
| BL.668-100 | 100 | 33 | 55 | M12 | 45 | 14 | 15 | 120 | · |
| BL.668-110 | 135 | 33 | 55 | M12 | 80 | 14 | 15 | 156 | · |
| BL.668-120 | 175 | 33 | 55 | M12 | 120 | 14 | 15 | 216 | · |
| BL.668-130 | 70 | 33 | 55 | M14 | 15 | 16 | 15 | 96 | △ |
| BL.668-140 | 108 | 33 | 55 | M14 | 53 | 16 | 15 | 154 | △ |
| BL.668-150 | 129 | 33 | 55 | M14 | 74 | 16 | 15 | 186 | △ |
| BL.668-160 | 155 | 33 | 55 | M14 | 100 | 16 | 15 | 228 | △ |

PS. 備註

· 手柄不可拆卸，使用溫度BL.666：MAX.110°C，MIN.-20°C
BL.668：MAX.90°C，MIN.-20°C

訂貨： 交期： 天 ·
BL.666-010 天 △